

**MATERIAL**

- 1) BODY - DUCTILE IRON
- 2) CAP - ALUMINUM
- 3) PISTON - ALUMINUM
- 4) POPPET - ALUMINUM AND BRASS
- 5) POPPET SPRING - STAINLESS STEEL
- 6) MAIN SPRING - STEEL

**PORT OPTIONS**

- 1) BODY SIDE PORTS - 1/8, 1/4 NPTF, BSPT or 1/8 ORB
- 2) BODY BACK PORT - 1/8, 1/4, 1/2 NPT, BSPT or 1/8, 1/4, 1/2, 3/4 ORB

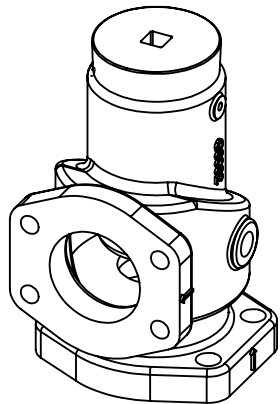

UNLESS OTHERWISE SPECIFIED:

DIMENSIONS ARE IN INCHES  
 TOLERANCES:  
 CASTINGS:  $\pm 1/16$   
 ANGULAR: MACH  $\pm 1.0$  DEGS  
 TWO PLACE DECIMAL:  $\pm 0.010$   
 THREE PLACE DECIMAL:  $\pm 0.005$   
 BREAK EDGE: 0.005-0.010

DWG PER ANSI STANDARD  
 INTERPRET GEOMETRIC  
 TOLERANCING PER: ANSI Y14.5M

MATERIAL  
 DI  
 FINISH  
 125

DO NOT SCALE DRAWING



P.O. Box 8565  
 Erie Pa 16505 USA  
 Phone: 814-838-6373  
 Fax: 814-835-1282  
 email -  
 info@air-convalves.com

PART NAME:

**Dimensions and Material**

SIZE  
**A**

DWG. NO.  
**MP0201**

REV  
**A**

SCALE: 1:4

WEIGHT: 11.17 LB

SHEET 1 OF 1

	NAME	DATE
DRAWN	WRC	13 DEC 2010
APPROVED	WRC	13 DEC 2010

**PROPRIETARY AND CONFIDENTIAL**  
 THE INFORMATION CONTAINED IN THIS DRAWING IS THE SOLE PROPERTY OF AIR-CON INC. ANY REPRODUCTION IN PART OR AS A WHOLE WITHOUT THE WRITTEN PERMISSION OF AIR-CON INC. IS PROHIBITED.