

- MATERIAL**
- 1) BODY - DUCTILE IRON
  - 2) CAP - ALUMINUM
  - 3) PISTON - ALUMINUM
  - 4) POPPET - ALUMINUM AND BRASS
  - 5) POPPET SPRING - STAINLESS STEEL
  - 6) MAIN SPRING - STEEL

- THREAD OPTIONS**
- 1) INLET/OUTLET THREADING - 1-1/2 NPT, BSPP, BSPT Or ORB
  - 2) BODY SIDE PORTS - NONE, 1/8, 1/4 NPTF, BSPP, BSPT or 1/8 ORB
  - 3) BODY BACK PORT - NONE, 1/8, 1/4, 1/2 NPTF, BSPP, BSPT or ORB

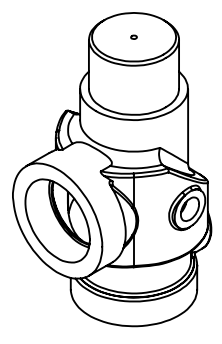
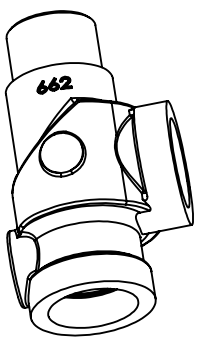

UNLESS OTHERWISE SPECIFIED:  
 DIMENSIONS ARE IN INCHES  
 TOLERANCES:  
 CASTINGS: ±1/16  
 ANGULAR: MACH ±1.0 DEGS  
 TWO PLACE DECIMAL: ±0.010  
 THREE PLACE DECIMAL: ±0.005  
 BREAK EDGE: 0.005-0.010

	NAME	DATE
DRAWN	WRC	31 MAR 2011
APPROVED	WRC	31 MAR 2011

**PROPRIETARY AND CONFIDENTIAL**  
 THE INFORMATION CONTAINED IN THIS DRAWING IS THE SOLE PROPERTY OF AIR-CON INC. ANY REPRODUCTION IN PART OR AS A WHOLE WITHOUT THE WRITTEN PERMISSION OF AIR-CON INC. IS PROHIBITED.

DWG PER ANSI STANDARD  
 INTERPRET GEOMETRIC  
 TOLERANCING PER: ANSI Y14.5M  
 MATERIAL  
 60-40-18 DI  
 FINISH  
 125  
 DO NOT SCALE DRAWING

**AIR-CON, INC**  
*Manufacturers of Air Control Valves*  
 P.O. Box 8565  
 Erie Pa 16505 USA  
 Phone: 814-838-6373  
 Fax: 814-835-1282  
 email - info@air-convalves.com

PART NAME:  
**Dimensions and Material**

SIZE <b>A</b>	DWG. NO. <b>MP0511</b>	REV <b>A</b>
SCALE: 1:3	WEIGHT: 5.46 Lbf	SHEET 1 OF 1